

Butterfly Valves

BATLEY® & BDK™

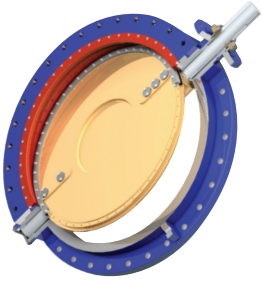

Softseal

Features

- Low cost option for low temperature water sealing
- Rubber seal located on valve disk
- Single & double offset designs

Class - ASME 150-600
Sizes - 6" - 80" (150mm-2000mm)

BATLEY® & BDK™

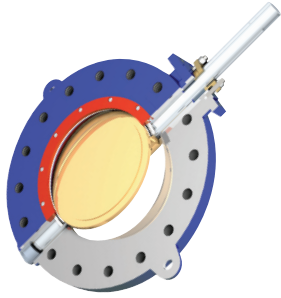

Hyperseal/Metalseal

Features

- Single & double offset designs
- Seal clamped into valve body
- Resilient seated, metal seated, fire safe & swing through options

Class - ASME 150-900
Sizes - 3" - 64" (80mm-1600mm)

BATLEY® & BDK™

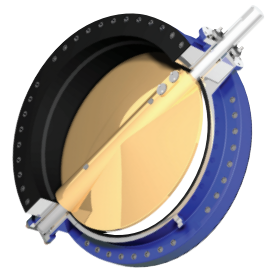

Rubber Lined

Features

- Low cost solution for controlling low temperature corrosive fluids
- Body & shaft material fully isolated from fluid

Class - ASME 150-300
Sizes - 3" - 64" (80mm-1600mm)

Globe, Three Way & Wedge Gate Valves

BDK™



Low Pressure Wedge Gate

Features

- Sealing by wedge disk
- High integrity closure
- Ideal for general service shut-off applications
- Flanged bonnet

Class - ASME 150-2500
Sizes - 1/2" - 120" (15mm-3000mm)

BDK™



Pressure Seal Bonnet Wedge Gate

Features

- Sealing by wedge disk
- High integrity closure
- Pressure seal bonnet
- Bypass designs available

Class - ASME 900-2500
Sizes - 12" - 120" (300mm-3000mm)

Ball, Check, Diaphragm & Plug Valves

BDK™



2 Piece Trunnion Ball

Features

- Ability to offer in smaller sizes
- Low emission & positive sealing
- Constant operating torques
- Proven design
- Smooth operation

Class - ASME 150-2500

Sizes - 2" - 48" (50mm-1200mm)

BDK™



3 Piece Trunnion Ball

Features

- Ability to offer in smaller sizes
- Low emission & positive sealing
- Constant operating torques
- Proven design
- Smooth operation

Class - ASME 150-2500

Sizes - 2" - 48" (50mm-1200mm)

BDK™

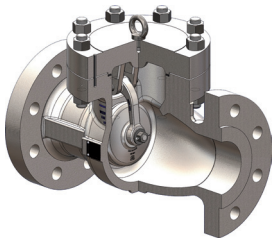

Check

Features

- Heavy duty cover
- Pressure seal cover available
- Integral seat ring

Class - ASME 150-2500

Sizes - 2" - 48" (50mm-1200mm)

BDK™



Diaphragm

Features

- Manually operated or diaphragm operated
- Weir type design option
- Straight type design option
- Can be instrumented for control

Class - ASME 150-300

Sizes - 1/2" - 14" (15mm-350mm)

BDK™



Plug

Features

- PTFE sleeved
- Fully jacketed with higher size flange
- Complies to API 599, BS 5353, API 6D

Class - ASME 150-600

Sizes - 1/2" - 16" (15mm-400mm)